



4 in 1 Autofocus 4MP Indoor / Outdoor IR Dome

IV-DV720IR4MP-FH-AF

Features:

- . 4MP@TVI/CVI/AHD/CVBS video output
- . 1/2.9" SONY EXmor CMOS
- . 100 dB Double Shutter WDR
- . Auto Defog, HLC, Privacy mask, motion detection, 32X Sense up
- . 2D/3D DNR, anti-ghost effect
- . Multi Languages OSD Control from Recorder
- . DC12V (AC24V Optional)

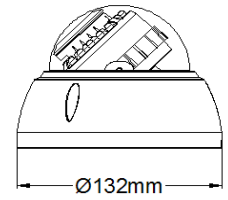
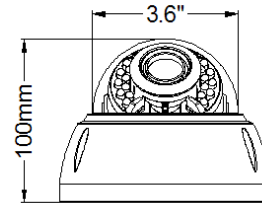

Junction Box (optional)
IV-JBK02W



Use the OSD joystick to switch among the four video output modes:

- * Push the joystick "UP" button key over 5 seconds to CVI mode
- * Push the joystick "DOWN" button key over 5 seconds to TVI mode
- * Push the joystick "LEFT" button key over 5 seconds to CVBS (Analog 960H) mode
- * Push the joystick "RIGHT" button key over 5 seconds to AHD mode
- ** Each Boot up allows one video mode selection.

if you need to switch to another mode, you will need to reboot again.

Specification	IV-DV720IR4MP-FH-AF
Horizontal Resolution	4MP@ TVI / CVI / AHD / CVBS
Image Sensor	1/2.9" SONY Exmor CMOS
Effective Pixels	2592(H) x 1520 (V)
Resolution	Digital: 2592 x 1520 (4MP/30fps) Analog: 700TVL
S/N Ratio	≥50dB (AGC Off)
Min. Illumination	COLOR: 0.1Lux@(F2.0, AGC ON) B&W: 0.001Lux@(F2.0, AGC ON)
Scanning System	Progressive
Video Output	HD-Analog: HD-CVI (TVI, AHD) (4MP) Analog: 1Vp-p Composite Output (75Ω/BNC)
Day&Night	EXTERN, COLOR, B&W, AUTO
White Balance	Auto
OSD	English / Chinese
Defog	OFF/ON
WDR	OFF/LOW/MIDDLE/HIGH
Privacy Mask	ON/OFF (16 Areas)
Motion Detection	ON/OFF (4 Areas)
IR LED	24pcs IR LED
Lens	2.8-12mm Auto Focus
IR Range	65.6ft (20m)
Input Voltage	DC12V±10% (AC24V Optional)
Current	380MA
Power Consumption	< 5W
Weight	1.28lbs (580g)
IP Rating	IP66
Dimensions	∅5.2" x 3.94" (∅132mm x 100mm)